

UNITED STATES PUBLIC LAND SURVEY CORNER CERTIFICATE

LAND SURVEY MONUMENTS SITUATED IN SECTION 10, TOWNSHIP 86,
RANGE 4W, OF THE 5th. PRINCIPAL MERIDIAN, JONES
COUNTY, IOWA.

N NO SCALE

RECOVERY TIE DRAWING

SW CORNER

NW CORNER

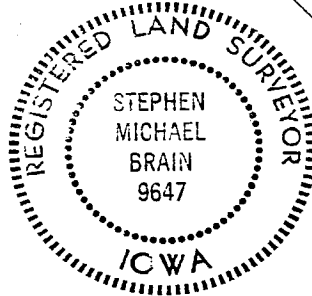
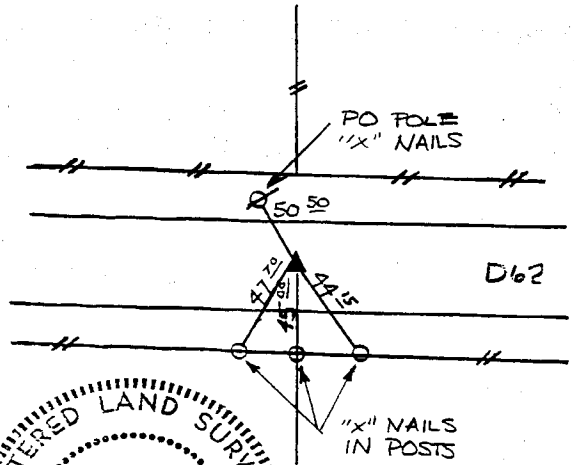
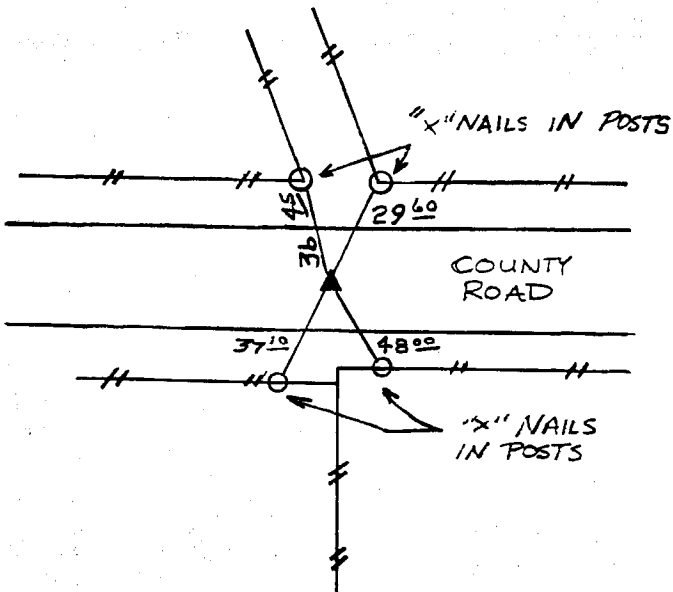
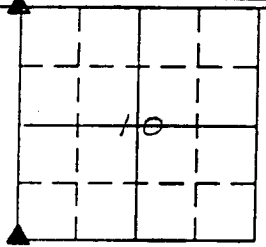

ON CARD NE COR SEC. 16 M.S.

ON CARD NE. SEC 9 M.S.

PREVIOUSLY RECORDED IN BOOK 121 PAGE 39

PREVIOUSLY RECORDED IN BOOK 121 PAGE 39

MONUMENT DESCRIPTION AND HOW ESTABLISHED:
FOUND SPIKE 2" BELOW SURFACE

MONUMENT DESCRIPTION AND HOW ESTABLISHED:
FOUND P.K. SPIKE 3" BELOW SURFACE

I HEREBY DECLARE THAT THE SURVEY WORK WAS COMPLETED AND THIS CERTIFICATE WAS PREPARED BY ME OR UNDER MY DIRECT PERSONAL SUPERVISION AND THAT I AM A DULY REGISTERED LAND SURVEYOR UNDER THE LAWS OF THE STATE OF IOWA.

Stephen Michael Brain 1-10-93
STEPHEN MICHAEL BRAIN, P.E. & L.S. 9647

List Corners to be Indexed			
Corners	Section	Twp	Range
SW	10	86	4W
NW	10	86	4W