

**Index Legend**

Location: Section 4, T84N, R4W, NE of NW  
 Section 4, T84N, R4W, NW of NW  
 Surveyor: Dennis Michael, PLS No. 23526  
 Surveyor  
 Company: Michael Surveying, LLC  
 Return To: Dennis Michael  
 2654 Crimson Avenue  
 Fruitland, Iowa 52749  
 dennis@michaelsurveyingllc.com  
 (563) 506-4755

For County Recorder Use

Number: 2018-1057  
 Recorded: 4/27/2018 at 11:33:42.0 AM  
 Fee Amount: \$7.00  
 Revenue Tax:  
 Sheri L. Jones RECORDER  
 Jones County, Iowa

**UNITED STATES PUBLIC LAND SURVEY CORNER CERTIFICATE OF**

Land Survey Monuments situated in Section 4, Township T84N, Range R4W, of the Fifth Principal Meridian, Jones County, Iowa.

No previously recorded certificate found in the Office of the Jones County Recorder.

Monument Description and Remarks: Found 1'x1' concrete monument 1.5' above ground and measured. The monument was leaning slightly west and the top of the monument was stamped "NW NE SW Sec 33". This monument has been used in prior surveys as the Northwest Corner of the NE 1/4 of the NW 1/4 of Section 4. No previous record certificate was found.

\* Note: All ties measured with Nyclad Steel Tape

**Plan View**

Iowa Regional Coordinate System  
 Zone 10 Cedar Rapids  
 NAD83 (2011) Datum, Geoid12B  
 Found 1'x1' Concrete Monument  
 N8,105,369.48Ft, E20,593,672.49Ft  
 GPS Measured by DM & TP on 4/7/2018

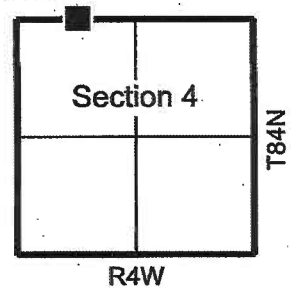

Northwest Corner, NE-NW  
 Section 4, T84N, R4W  
 Found 1'x1' concrete monument  
 1.5' above ground

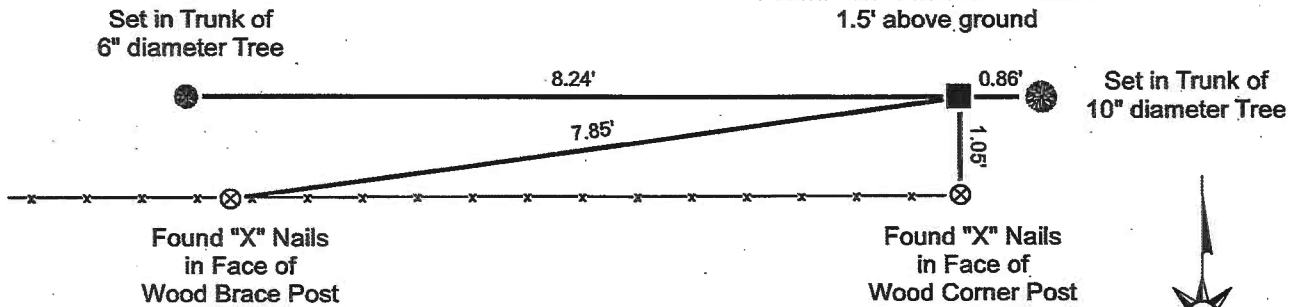

Note:  
 All ties are nails with blue plastic disks stamped "Dennis C Michael, Iowa PLS 23526", unless otherwise noted.

No Scale

**Northwest Corner, NE 1/4 - NW 1/4** (X.XX') Denotes Record Distance

I hereby certify that this land surveying document was prepared and the related survey work was performed by me or under my direct personal supervision and that I am a duly licensed Professional Land Surveyor under the laws of the State of Iowa.

Signed: *[Signature]* Date: 4/26/18  
 Dennis C. Michael, PLS, No. 23526  
 My license renewal date is December 31, 2019.

Pages or sheets covered by this seal: Sheet 1 of 1.

SEAL:

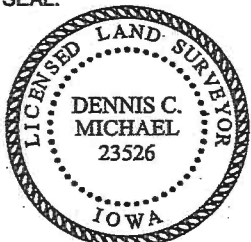

List Corners to be Indexed

Corner	Section	Twp	Range
NW Cor, NE-NW	4	T84N	R4W
NE Cor, NW-NW	4	T84N	R4W

**MICHAEL SURVEYING, LLC**

2654 Crimson Avenue  
 Fruitland, Iowa 52749  
 Phone: (563) 506-4755