

2005 3159

FILED
RECORDERS OFFICE
JONES COUNTY IOWA

05 SEP -6 PM 12:31

MARIE KRUTZFIELD
RECORDER 7.00 Pd

SLSI 9-90

Prepared By: Leo D. Wooder, L.S. #14676 Anderson-Bogert Engineers & Surveyors, Inc.
4001 River Ridge Dr. N.E. Cedar Rapids, Iowa 52402 Phone: (319) 377-4629

UNITED STATES PUBLIC LAND SURVEY CORNER CERTIFICATE OF

Land Survey Monuments situated in Section 7, Township 83N, Range 4W, of the Fifth Principal Meridian, Jones County, Iowa.
Previously recorded in _____ Not Previously Recorded _____ in County Recorders Office.
(book, page, document number, ect.)

(Show reason for preparing this certificate, the evidence and detailed procedures used in establishing the corner positions and monumentation found or placed.)

Monument Description and Remarks: W¹/₄ Cor Sec 7 FD Conc Mon. W/ Top Broken off SW Cor Sec 7 FD ¹/₂" IR Buried in Road, FD from Ties in Jones County Engineers Office. Corners were Found or Set for Survey Recorded as Instrument #20053039 in the Jones County Recorders Office.

PLAN - VIEW

(Show a minimum of three reference ties to durable physical objects, relevant monuments and physical conditions that will enable recovery of the corner.)

834076-091905-tie

1242 ✓✓

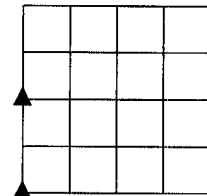

SECTION - 7

1253 ✓

N

834076-091905-tie
834182

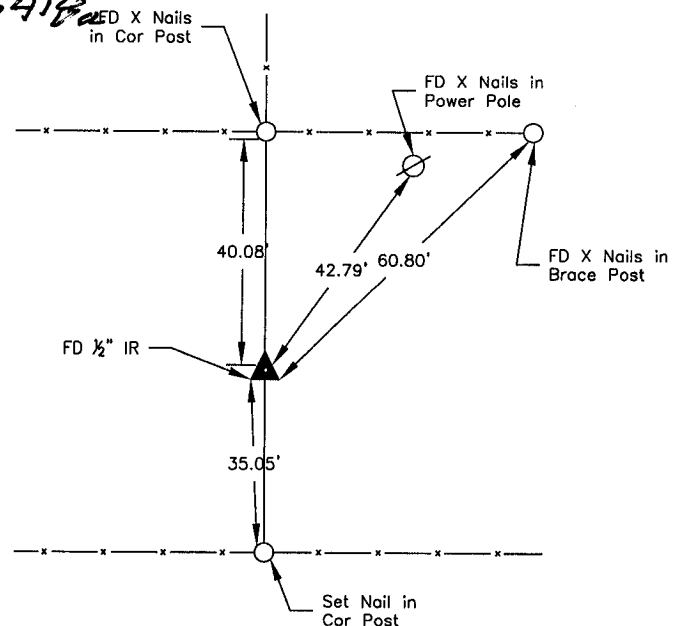
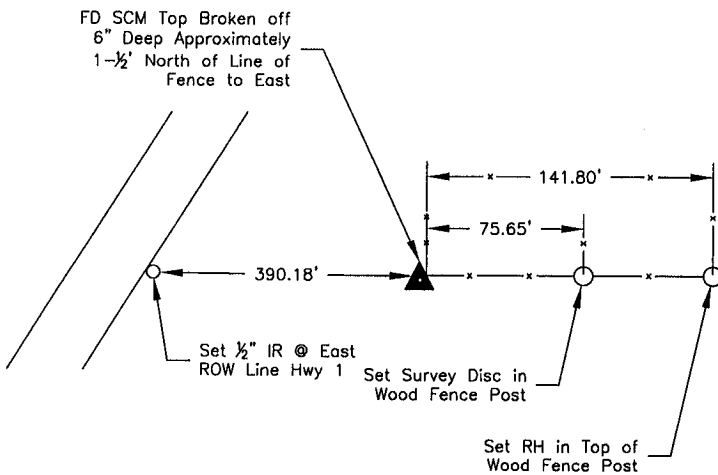

W1/4 Cor 7-83-4

SW Cor 7-83-4

I hereby certify that this land surveying document was prepared and the related survey work was performed by me or under my direct personal supervision and that I am a duly licensed Land Surveyor under the laws of the State of Iowa

Signature: *Leo D. Wooder* Date: 9/06/2005

List Corners to be Indexed

Corners	Section	Twp	Range
W ¹ / ₄ Cor	7	83	4

THIS IS NOT A CERTIFICATION

JONES COUNTY ENGINEER'S OFFICE, 19501 HWY. 64, ANAMOSA, IOWA, 52205 (319)462-3785

UNITED STATES PUBLIC LAND SURVEY CORNER CERTIFICATE

LAND SURVEY MONUMENTS SITUATED IN SECTION 18, TOWNSHIP 83
NORTH, RANGE 4 WEST OF THE 5TH P.M., JONES COUNTY, IOWA

CORNERS TO BE INDEXED

CORNER NORTHWEST	SECTION 18	TOWNSHIP 83N	RANGE 4W
---------------------	---------------	-----------------	-------------

OFFICE FILE NO. _____
83418a_081103.jpg

1253

ROADWAY

LINN COUNTY ENGINEER
INFORMAMTION.

PREVIOUSLY RECORDED IN BOOK _____, PAGE _____
MONUMENT DESCRIPTION AND HOW ESTABLISHED FD. 18"X8"X3"
BROKEN LIMESTONE 30' BELOW SURFACE ON NORTH ROAD SLOPE.
FD. STAKE OVER STONE. LOWERED STONE TO 4' BELOW, SET STANDARD
CONCRETE DIRECTLY ABOVE. TOP FLUSH WITH GROUND. NORTHWEST
CORNER SECTION 18, TOWNSHIP 83 NORTH, RANGE 4 WEST OF 5TH
PM, JONESS COUNTY, IOWA.

CORNERS TO BE INDEXED

CORNER N-1/4	SECTION 18	TOWNSHIP 83N	RANGE 4W
-----------------	---------------	-----------------	-------------

OFFICE FILE NO. _____
83418c_081103.jpg

1254

ENGINEER'S CORNER STONE BOOK

PREVIOUSLY RECORDED IN BOOK #6, PAGE 52
MONUMENT DESCRIPTION AND HOW ESTABLISHED FOUND 18"X8"X6"
LIMESTONE STANDING ON END. LOWERED STONE AND SET STANDARD
CONCRETE DIRECTLY ABOVE. TIES AS INDICATED. NORTH QUARTER
CORNER SECTION 18, TOWNSHIP 83 NORTH, RANGE 4 WEST OF THE
5TH PM, JONES COUNTY, IOWA.

CORNERS TO BE INDEXED

CORNER	SECTION	TOWNSHIP	RANGE
--------	---------	----------	-------

OFFICE FILE NO. _____

NO SCALE

PREVIOUSLY RECORDED IN BOOK _____, PAGE _____
MONUMENT DESCRIPTION AND HOW ESTABLISHED _____

CORNERS TO BE INDEXED

CORNER	SECTION	TOWNSHIP	RANGE
--------	---------	----------	-------

OFFICE FILE NO. _____

NO SCALE

PREVIOUSLY RECORDED IN BOOK _____, PAGE _____
MONUMENT DESCRIPTION AND HOW ESTABLISHED _____

~~I hereby declare that this plat, survey or report was made by me or under my direct personal supervision and that I am a duly registered Land Surveyor under the laws of the State of Iowa.~~

Signed: _____

SEAL

JONES COUNTY
ENGINEER'S OFFICE

19501 HWY. 64,
ANAMOSA, IOWA,
52205 (319)462-3785