

2001 1594

FILED  
RECORDERS OFFICE  
JONES COUNTY IOWA

01 MAY 15 AM 10:10

MARIE KRUTZFIELD  
RECORDER No Fee

J.D. TJEPKES, L.S. JONES COUNTY ENGINEER'S OFFICE, 19501 HWY. 64, ANAMOSA, IOWA, 52205 (319)462-3785

# UNITED STATES PUBLIC LAND SURVEY CORNER CERTIFICATE

LAND SURVEY MONUMENTS SITUATED IN SECTION 12, TOWNSHIP 83  
NORTH, RANGE 2 WEST OF THE 5TH P.M., JONES COUNTY, IOWA

**CORNERS TO BE INDEXED**

CORNER	SECTION	TOWNSHIP	RANGE
NORTHEAST	12	83N	2W

OFFICE FILE NO. 83212e\_041201

PREVIOUSLY RECORDED IN BOOK 334, PAGE 48  
MONUMENT DESCRIPTION AND HOW ESTABLISHED FOUND  
3/4" IRON PIN SOUTHEAST OF ROAD EDGE PER  
RECORDED TIES. SET NEW REFERENCE POINTS  
AND TIED OUT AS INDICATED. N.E. COR. SECTION 12, TOWNSHIP  
83 NORTH, RANGE 2 WEST, JONES COUNTY, IOWA

**CORNERS TO BE INDEXED**

CORNER	SECTION	TOWNSHIP	RANGE
NORTH 1/4	12	83 NORTH	2 WEST

OFFICE FILE NO. 83212c\_041201

PREVIOUSLY RECORDED IN BOOK N/A, PAGE N/A  
MONUMENT DESCRIPTION AND HOW ESTABLISHED SET 5/8" X  
48" REBAR W/CAP LS 14807 2' SOUTH OF EAST-WEST FENCE ON EVEN  
SPLIT BETWEEN N.E. COR. AND N.W. COR. SECTION 12, TOWNSHIP 83  
NORTH, RANGE 2 WEST, JONES COUNTY, IOWA. SET REFERENCE POINTS  
AND TIED OUT AS INDICATED.

**CORNERS TO BE INDEXED**

CORNER	SECTION	TOWNSHIP	RANGE
SE COR. NE QUARTER, NW QUARTER	12	83 NORTH	2 WEST

OFFICE FILE NO. 83212h\_041201

PREVIOUSLY RECORDED IN BOOK N/A, PAGE N/A  
MONUMENT DESCRIPTION AND HOW ESTABLISHED SET 5/8" X 48"  
REBAR WITH CAP LS 14807 IN NORTH-SOUTH FENCE LINE BY  
SECTION BREAKDOWN. SET REFERENCE POINTS AND TIED OUT AS  
INDICATED. SOUTHEAST CORNER, NORTHEAST QUARTER, NORTHWEST  
QUARTER SECTION 12, T83N, R2W, JONES COUNTY, IOWA

**CORNERS TO BE INDEXED**

CORNER	SECTION	TOWNSHIP	RANGE
CENTER	12	83N	2W

OFFICE FILE NO. 83212m\_041201

PREVIOUSLY RECORDED IN BOOK N/A, PAGE N/A  
MONUMENT DESCRIPTION AND HOW ESTABLISHED DRILLED HOLE  
IN CONC. PAVEMENT. SET 5/8" X 24" REBAR WITH CAP LS 14807 BY  
CROSSING THE SECTION FOR NORTH-SOUTH POSITION AND ON LINE  
WITH FENCE TO SOUTH FOR EAST-WEST POSITION. CENTER OF  
SECTION 12, TOWNSHIP 83 NORTH, RANGE 2 WEST, JONES COUNTY, IA

I hereby declare that this plat, survey or report was made by me or under my direct personal supervision and that I am a duly registered Land Surveyor under the laws of the State of Iowa.

Signed: *Joseph D. Tjepkes* 4.12.01

Joseph D. Tjepkes L.S. Iowa Reg. No. 14807  
My Registration Renewal Date is December 31, 2002

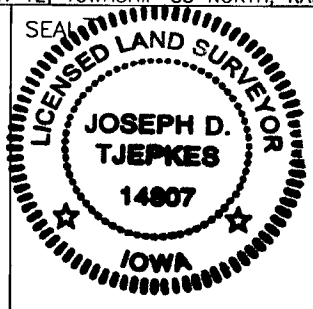

J.D. TJEPKES LS 14807  
JONES COUNTY  
ENGINEER'S OFFICE

19501 HWY. 64,  
ANAMOSA, IOWA,  
52205 (319)462-3785

# SECTION CORNER CERTIFICATE

OF  
 LAND SURVEY MONUMENTS SITUATED IN SECTION 1, TOWNSHIP 83 NORTH,  
 RANGE 2 WEST, OF THE FIFTH PRINCIPAL MERIDIAN, JONES, COUNTY, IOWA.

PREVIOUSLY RECORDED IN BOOK \_\_\_\_\_ AT PAGE \_\_\_\_\_.

FOR RECORDER'S USE

**REASON FOR PREPARING CERTIFICATE:**

- A) THERE IS NO CERTIFICATE FOR THE CORNER ON FILE WITH THE RECORDER OF THE COUNTY IN WHICH THE CORNER IS LOCATED.
- B) CORNER POSITION DIFFERS FROM THAT SHOWN IN THE PUBLIC RECORDS OF THE COUNTY IN WHICH THE CORNER IS LOCATED.
- C) THE CORNER MONUMENT HAS BEEN REPLACED OR MODIFIED.
- D) THE REFERENCE TIES REFERRED TO IN AN EXISTING PUBLIC RECORD ARE INCORRECT.

*B. 33 EJ  
P. 48*

**MONUMENT DESCRIPTION AND REMARKS :**

*FOUND 3/4" IRON PIN AT BOTH CORNER LOCATIONS SHOWN HERE.*

## RECOVERY TIE DRAWING

NE COR. SE 1/4, 1-83-2

SE COR. SE 1/4, 1-83-2

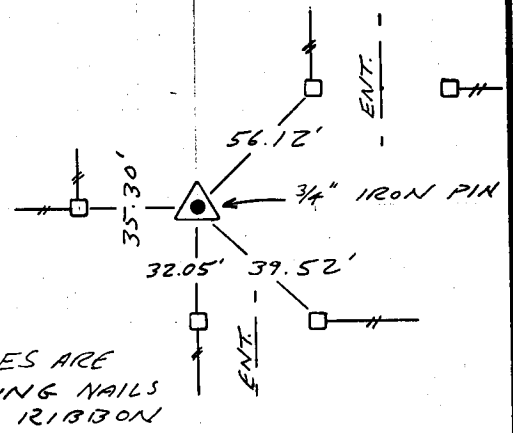
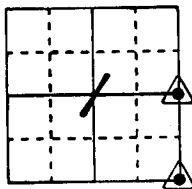
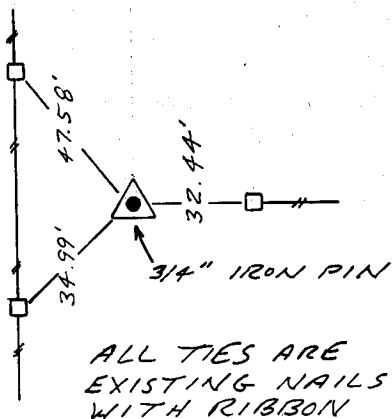

*3-2-93 ON CARD E4 SEC 12 M.S.*

*3-2-93 ON CARD NE COR SEC. 12 M.S.*

I, DEAN E. BERANEK, CERTIFY THAT THE CORNER LOCATION(S) SHOWN ON THIS RECORD WERE DETERMINED BY ME OR UNDER MY DIRECTION AND CONTROL AND THAT THIS U.S. PUBLIC LAND SURVEY MONUMENT RECORD IS CORRECT AND COMPLETE TO THE BEST OF MY KNOWLEDGE AND BELIEF.

*Dean Beranek 2-23-93*  
 DEAN E. BERANEK L.S. NO 10435 DATE  
 MY BIENNIAL REGISTRATION EXPIRES DECEMBER 31, 1993.

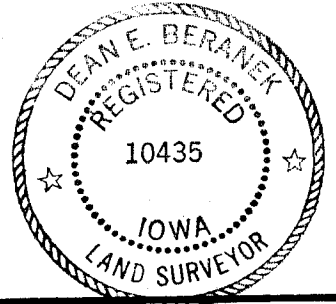

LEGEND	<input checked="" type="checkbox"/> GOVERNMENT CORNER	SHEET TITLE: U.S. PUBLIC LAND SURVEY RECORD		MMS CONSULTANTS, INC. Iowa City, Iowa 319-351-8282
	<input type="checkbox"/> 5/8" TIE PIN SET	PROJECT TITLE: SECTION CORNER TIES		
<input type="checkbox"/> CENTERLINE		SCALE: NONE	F NO: 312	P NO: 3405-001
<input type="checkbox"/> EXISTING FENCE LINE				
<input type="checkbox"/> R.O.W. LINE				
DATE: 1-25-93	APP: DEB	CHECK: JAH		