

UNITED STATES PUBLIC LAND SURVEY CORNER CERTIFICATE

LAND SURVEY MONUMENTS SITUATED IN SECTION 12, TOWNSHIP 84 NORTH
RANGE 2 WEST OF THE 5TH P.M., JONES COUNTY, IOWA.

NO SCALE



NW SW 1/4 NE 1/4

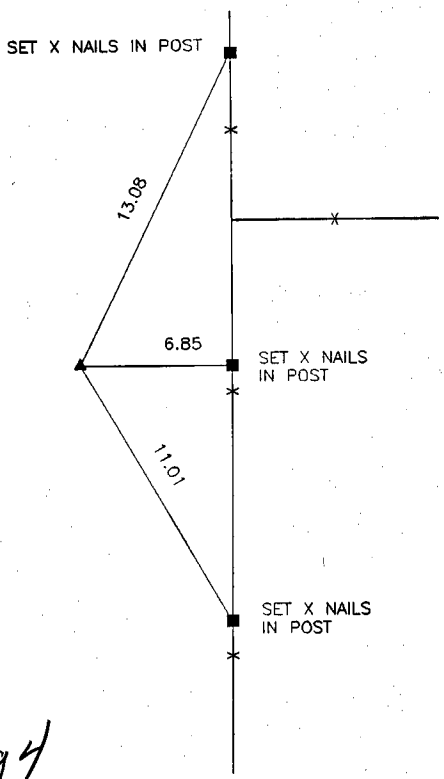
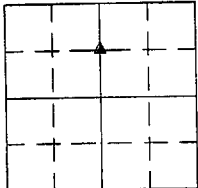

*on
Card
1-1-94*

PREVIOUSLY RECORDED IN BOOK _____ PAGE _____
MONUMENT DESCRIPTION AND HOW ESTABLISHED _____
SET 1/2" REBAR W/ CAP #9647

NO SCALE

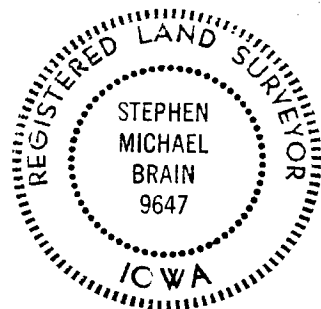
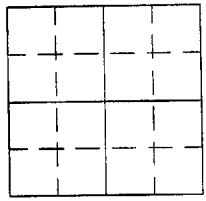

PREVIOUSLY RECORDED IN BOOK _____ PAGE _____
MONUMENT DESCRIPTION AND HOW ESTABLISHED _____

I hereby declare that this plat, survey or report was made by me or under my direct personal supervision and that I am a duly registered Land Surveyor under the laws of the State of Iowa.
Signed Stephen Michael Brain Date 5/23/94
Stephen Michael Brain, P.E. & L.S. Iowa Reg No. 9647

CORNERS TO BE INDEXED
CORNER SECTION TOWNSHIP RANGE
NW SW1/4 NE1/4 12 84N 2W

BRAIN ENGINEERING, INC.
700 11TH STREET, SUITE 201
MARION, IOWA 52302
(319) 373-1318