

2005 4201

FILED  
RECORDERS OFFICE  
JONES COUNTY IOWA

05 NOV 21 AM 11:43

MARIE KRUTZFIELD  
RECORDER 7.00 Pd

WASHINGTON

PREPARED BY: MICHAEL J. WEBER, WEBER SURVEYING, LLC, 26789 46TH AVE, BERNARD, IA 52032 (563) 879-4173

# UNITED STATES PUBLIC LAND SURVEY CORNER CERTIFICATE OF

LAND SURVEY MONUMENTS SITUATED IN SECTION 12, TOWNSHIP 86 NORTH, RANGE 1 WEST  
OF THE FIFTH PRINCIPAL MERIDIAN, JONES COUNTY, IOWA,  
PREVIOUSLY RECORDED NONE UNLESS OTHERWISE NOTED  
(book, page, document number, etc.)

(Show reason for preparing this certificate, the evidence and detailed procedures used in establishing the corner positions and monumentation found or placed.)

Monument Description and Remarks:

THE FOLLOWING CORNERS WERE USED AND IDENTIFIED ON THE PLAT OF SURVEY OF PARCEL 2005-198

S 1/4 CORNER FOUND SPIKE PER PLAT OF SURVEY IN PLAT BOOK-J, PAGE 83, SPIKE WAS ONLINE FROM THE CENTER OF SECTION TRHU THE SW CORNER OF THE NW-SE

## PLAN - VIEW

(Show a minimum of three reference ties to durable physical objects, relevant monuments and physical conditions that will enable recovery of the corner.)

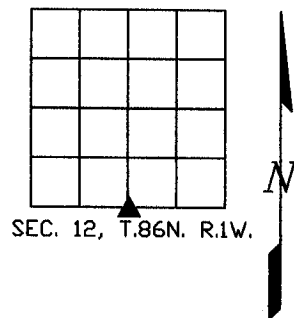

SET 5/8"  
DIA ROD  
W/ORANGE  
CAP NO.  
15084

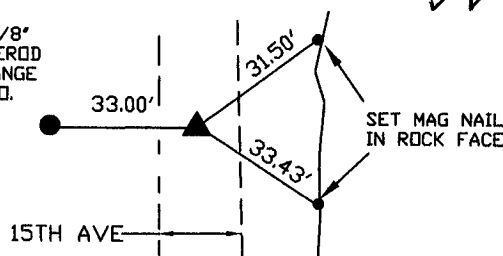

vv (N 1/4 - 13-86-1)

(1757)

861130 - 1118.05. tie

S 1/4 CORNER FOUND SPIKE  
PER PLAT OF SURVEY IN  
PLAT BOOK-J, PAGE 83,  
SPIKE WAS ONLINE FROM THE  
CENTER OF SECTION TRHU