

Marie Krutzfield, Recorder  
 Jones County, Iowa

Prepare's Name: Buesing & Associates Address: 1212 Locust St. Dubuque, IA Telephone: (563) 556-4389

SLSI 9-94

UNITED STATES PUBLIC LAND SURVEY CORNER CERTIFICATE

OF

Land Survey Monuments situated in Section 14, Township 86N, Range 1W, of the Fifth Principal Meridian, DUBUQUE County, Iowa.  
 Previously recorded in NONE in County Recorder's Office.  
(book, page, document number, etc.)

(Show reason for preparing this certificate, the evidence and detailed procedures used in establishing the corner positions and monumentation found or placed.)

Monument Description and Remarks: PLACED 5/8" IRON REROD W/ORANGE PLASTIC CAP MARKED "KOELKER 15487" W/ANGLE IRON @ THE SW CORNER OF THE NE1/4 SE1/4. FLUSH WITH GROUND. ESTABLISHED BY INTERSECTION 1/4 1/4 SECTION LINES OF THE SE1/4.

PLAN - VIEW

(Show a minimum of three reference ties to durable physical objects, relevant monuments and physical conditions that will enable recovery of the corner.)

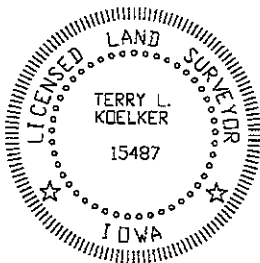
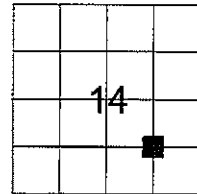
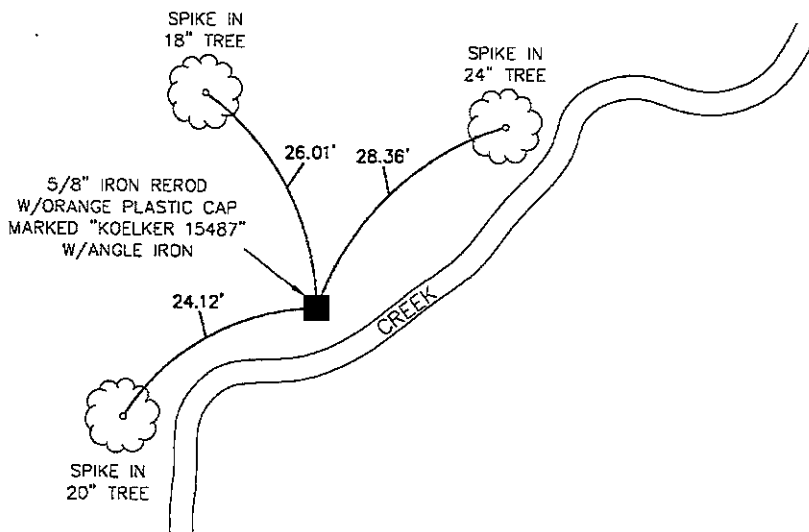

I HEREBY CERTIFY THAT THIS LAND SURVEYING DOCUMENT WAS PREPARED AND THE RELATED SURVEY WORK WAS PERFORMED BY ME OR UNDER MY DIRECT PERSONAL SUPERVISION AND THAT I AM A DULY LICENSED LAND SURVEYOR UNDER THE LAWS OF THE STATE OF IOWA.

*Terry L. Koelker* 6/12/07  
 TERRY L. KOELKER (DATE)

LICENSE NUMBER 15487  
 MY LICENSE RENEWAL DATE IS DECEMBER 31, 2007

List Corners	Section	Twp	Range
SW COR. OF NE1/4 SE1/4	14	86N	1W

<b>BUESING &amp; ASSOCIATES INC.</b> ENGINEERS AND SURVEYORS 1212 LOCUST ST, DUBUQUE, IA (563) 556-4389	MONUMENT RECORD		
	COUNTY: <u>JONES</u> TOWNSHIP: <u>WASHINGTON</u>		
DATE PLOTTED: <u>6-11-07</u> DATE REVISED:	FIELD BOOK # <u>168</u> PAGE # <u>29</u>	DRAWING # <u>07062-04</u>	