

# SECTION CORNER CERTIFICATE

OF  
 LAND SURVEY MONUMENTS SITUATED IN SECTION 17, TOWNSHIP 86 NORTH,  
 RANGE 1 WEST, OF THE FIFTH PRINCIPAL MERIDIAN, JONES, COUNTY, IOWA.

PREVIOUSLY RECORDED IN BOOK \_\_\_\_\_ AT PAGE \_\_\_\_\_ .

FOR RECORDER'S USE

**REASON FOR PREPARING CERTIFICATE:**

- A) THERE IS NO CERTIFICATE FOR THE CORNER ON FILE WITH THE RECORDER OF THE COUNTY IN WHICH THE CORNER IS LOCATED.
- B) CORNER POSITION DIFFERS FROM THAT SHOWN IN THE PUBLIC RECORDS OF THE COUNTY IN WHICH THE CORNER IS LOCATED.
- C) THE CORNER MONUMENT HAS BEEN REPLACED OR MODIFIED.
- D) THE REFERENCE TIES REFERRED TO IN AN EXISTING PUBLIC RECORD ARE INCORRECT.

**MONUMENT DESCRIPTION AND REMARKS :**

N.E. CORNER - S.E. 1/4 - S.W. 1/4 SECTION 17 - T86N - R1W SET 1/2" REBAR  
 W/ L.S. CAP # 11954 12" DEEP 3 1/2' NORTH OF EAST WEST  
 FENCE

N.E. CORNER - S.E. 1/4 - S.E. 1/4 SECTION 17 - T86N - R1W SET 1/2" REBAR  
 W/ L.S. CAP # 11954 1' WEST OF NORTH-SOUTH FENCE 2" DEEP

## RECOVERY TIE DRAWING

N.E. COR. - S.E. 1/4 - S.W. 1/4 17-86-1

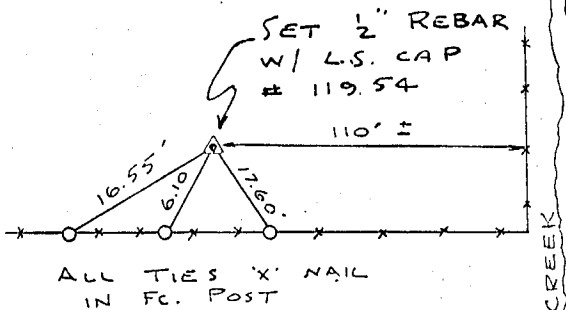

2-25-93  
 ON CARD M.S.

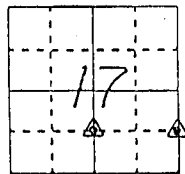

N.E. COR. - S.E. 1/4 - S.E. 1/4 17-86-1

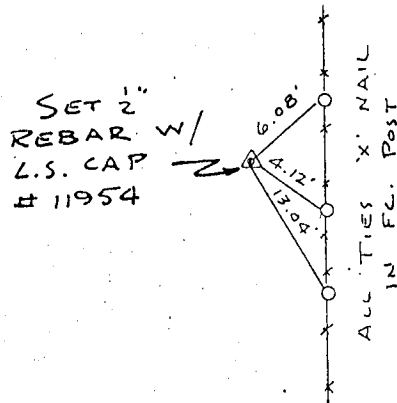

2-25-93 ON CARD M.S.

I, DANIEL J. JOHNSON, CERTIFY THAT THE CORNER LOCATION(S) SHOWN ON THIS RECORD WERE DETERMINED BY ME OR UNDER MY DIRECTION AND CONTROL AND THAT THIS U.S. PUBLIC LAND SURVEY MONUMENT RECORD IS CORRECT AND COMPLETE TO THE BEST OF MY KNOWLEDGE AND BELIEF.

*Daniel J. Johnson*  
 DANIEL J. JOHNSON L.S. NO 11954 DATE 12-30-92

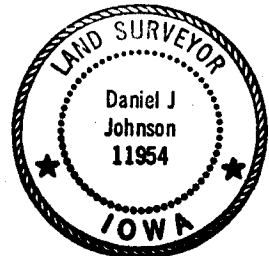

D I Z O R I E S	▲ GOVERNMENT CORNER ○ 5/8" TIC PIN SET --- CENTERLINE - - - EXISTING FENCE LINE - - - R.O.W. LINE	U.S. PUBLIC LAND SURVEY RECORD PROJECT TITLE: <b>JOSEPH STRANG JR. SURVEY</b>	HALL AND HALL ENGINEERS, INC. 226 29TH STREET DRIVE S.E. CEDAR RAPIDS, IOWA 52403 319-362-9548
	DW N R.W.B CH K D.J.J. APP	SHEET Dwg: _____ DATE 4-20-92 SCALE NONE	FNO B OT 25 PNO J 4671