

COPY

Jones County, Iowa
 Marie Krutzfield, Recorder
 Fee Book 2010 3417

12/09/2010 @0137PM
 ZSC SEC COR CERT
 Book: Page: # Pages: 1
 Total Fees: \$0.00

PREPARED BY
 CLARENCE J. WALTON, JONES COUNTY ENGINEER'S OFFICE, 19501 HWY. 64, ANAMOSA, IOWA, 52205 (319) 462-3785

UNITED STATES PUBLIC LAND SURVEY CORNER CERTIFICATE

LAND SURVEY MONUMENTS SITUATED IN SECTION 11, TOWNSHIP 85 NORTH,
 RANGE 3 WEST OF THE 5TH PRINCIPAL MERIDIAN, JONES COUNTY, IOWA.

OFFICE FILE NO.

STATE PLANE COORDINATE
 NAD 83 IOWA NORTH
 N 3539881.27
 E 5555263.94

CORNER CENTER SECTION 11 TOWNSHIP T85N RANGE R3W

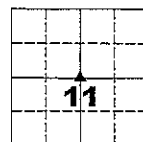

N

NO SCALE

NOTE:
 THE STATE PLANE COORDINATE AS INDICATED IS FOR CONVENIENCE ONLY.
 THE TIES AS SHOWN SHOULD BE USED TO REPLACE THE CORNER, IF DESTROYED

CULTIVATED FIELD

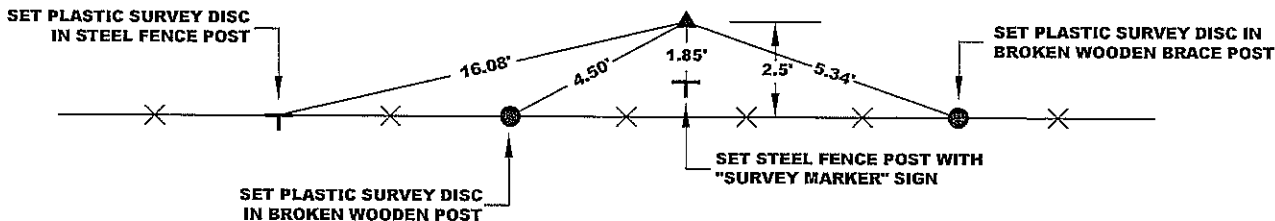

"SURVEY MARKER" SIGN

CULTIVATED FIELD

PLEASE PROTECT NEARBY
SURVEY MARKER
 IF LOCATION OF THIS MARK IS ENDANGERED PLEASE CONTACT JONES COUNTY ENGINEER'S OFFICE 319-462-3785

SURVEY DISC



OPC ORANGE PLASTIC CAP
 () RECORDED AS

PREVIOUSLY RECORDED IN RECORDER'S DOCUMENT N/A
 MONUMENT DESCRIPTION AND HOW ESTABLISHED SET 5/8"X48" REBAR WITH ORANGE PLASTIC CAP #11310 15" BELOW GROUND SURFACE AT INTERSECTION OF LINES BETWEEN OPPOSITE 1/4 SECTION CORNERS. THERE WAS A FAIR PLETHORA OF STONES IN THIS AREA, LARGE AND SMALL, MOSTLY LIMESTONE AND GRANITE. APPARENTLY, THEY WERE USE TO FILL IN A WASHOUT IN THE EXISTING EAST-WEST FENCE LINE. AT THE TIME THIS CORNER SET THERE WAS EXTENSIVE GRADING BEING DONE IN THE FIELD NORTH OF THE EAST-WEST FENCE, HENCE THE USE OF A LONGER THAN USUAL REBAR.
 FIELD BOOK 437, PAGE 75. DATE OF SURVEY: 11/4/10

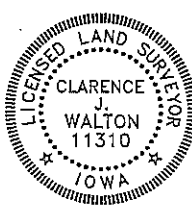

I hereby certify that this land surveying document and the related survey work was performed by me or under my direct personal supervision and that I am a duly registered Land Surveyor under the laws of the State of Iowa.
 Signed: *Clarence J. Walton* 12/9/10
 Clarence J. Walton, L.S.
 My Registration Renewal Date is December 31, 2011
 Iowa License Number 11310
 Pages or sheets covered by this seal: 1 of 1.

- A. THERE IS NO CERTIFICATE FOR THE CORNER ON FILE WITH THE RECORDER OF THE COUNTY IN WHICH THE CORNER IS LOCATED.
- B. THE CORNER MONUMENT HAS BEEN REPLACED OR MODIFIED.
- C. THE SURVEYOR IN RESPONSIBLE CHARGE OF THE LAND SURVEYING ACCEPTS A CORNER POSITION THAT DIFFERS FROM THAT SHOWN IN THE PUBLIC RECORDS OF THE COUNTY IN WHICH THE CORNER IS LOCATED.
- D. THE REFERENCE TIES REFERRED TO IN AN EXISTING PUBLIC RECORD NO LONGER EXIST.

CORNERS TO BE INDEXED

CORNER	SECTION	TOWNSHIP	RANGE
CENTER	11	85N	3W

JONES COUNTY ENGINEER'S OFFICE



19501 HWY. 64, ANAMOSA, IOWA 52205
 (319) 462-3785