

JONES COUNTY ENGINEER, 19501 HWY. 64, ANAMOSA, IOWA

UNITED STATES PUBLIC LAND SURVEY CORNER CERTIFICATE

LAND SURVEY MONUMENTS SITUATED IN SECTION 34, TOWNSHIP 85 NORTH, RANGE 3 WEST OF THE 5TH P.M., JONES COUNTY, IOWA

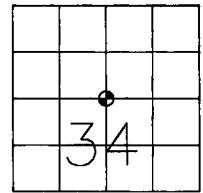
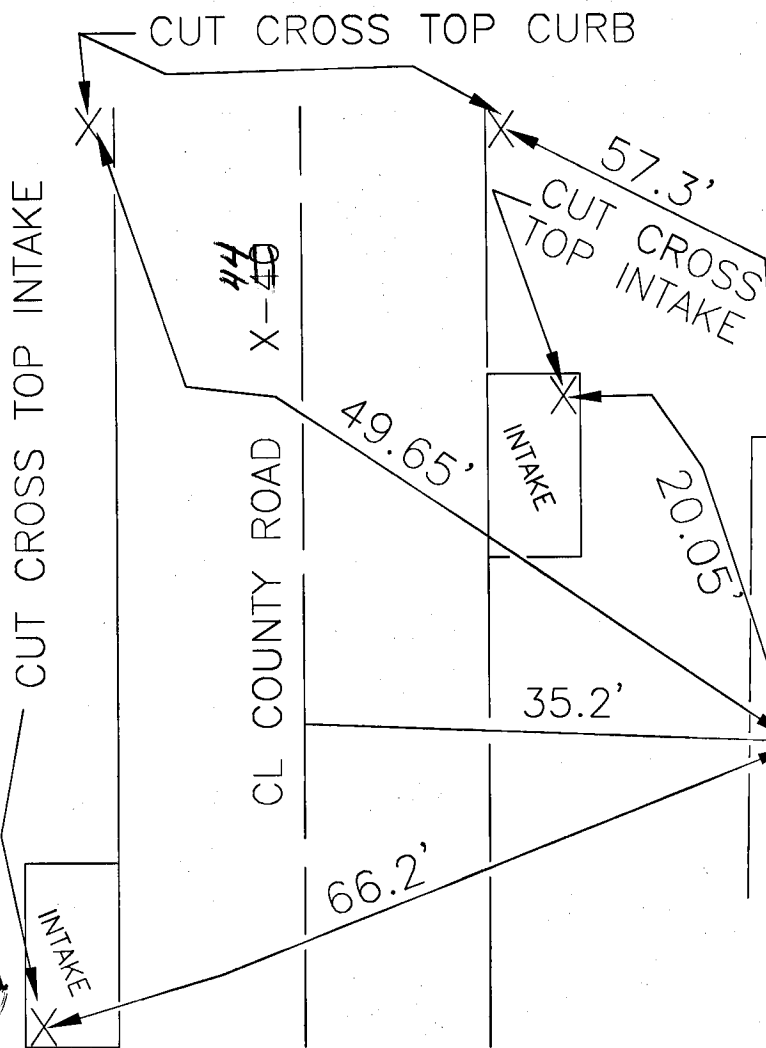

NO SCALE

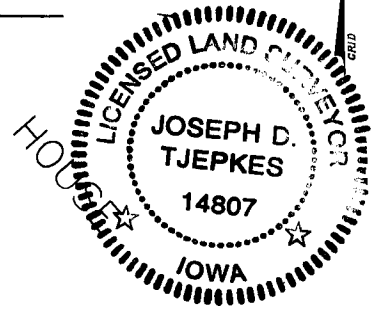

DRILLED HOLE IN CONC. WALK, SET 5/8"X24" REBAR WITH ORANGE CAP LS 14807
 CENTER SECTION 34, T85N,R3W

PREVIOUSLY RECORDED IN BOOK N/A, PAGE N/A
 MONUMENT DESCRIPTION AND HOW ESTABLISHED FOUND
CUT SQUARE IN CONC. WALK PER JONES COUNTY ENGINEER'S
FIELD BOOK 271, PAGE 74 ALSO ORIGINAL CORNER POSITION
INDICATED BY STONE PER TOWN PLAT OF AMBER (BLUE CUT)
DRILLED HOLE, SET 5/8"X24" REBAR WITH ORANGE CAP LS
14807 AND SET REFERENCE TIES AS INDICATED.

I hereby declare that this plat, survey or report was made by me or under my direct personal supervision and that I am a duly registered Land Surveyor under the laws of the State of Iowa.

Signed:

Joseph D. Tjepkes 5-9-2000

Joseph D. Tjepkes L.S. Iowa Reg. No. 14807
 My Registration Renewal Date is December 31, 2000

CORNERS TO BE INDEXED			
CORNER	SECTION	TOWNSHIP	RANGE
CENTER	34	T85N	R3W

JONES COUNTY ENGINEER
 19501 HWY. 64,
 ANAMOSA, IOWA