

UNITED STATES PUBLIC LAND SURVEY CORNER CERTIFICATE

OF

Land Survey Monuments situated in Section 25, Township 84N., Range 1W., of the Fifth Principal Meridian, JONES County, Iowa. Previously recorded in DOES NOT APPLY in County Recorder's Office.

(Show reason for preparing this certificate, the evidence and detailed procedures used in establishing the corner positions and monumentation found or placed.)

Monument Description and Remarks: SEE DESCRIPTION BELOW 2072

FILED
RECORDERS OFFICE
JONES COUNTY IOWA

97 JAN -7 AM 9:50

BOOK 416 PAGE 18
LINDA J. BENDIXEN
RECORDER

PLAN - VIEW

(Show a minimum of three reference ties to durable physical objects, relevant monuments and physical conditions that will enable recovery of the corner.)

NOTE: ALL TIES ARE SLOPE DISTANCES

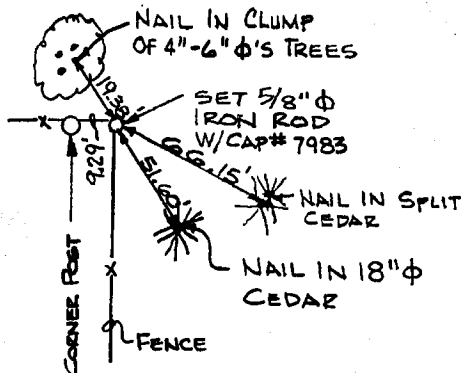
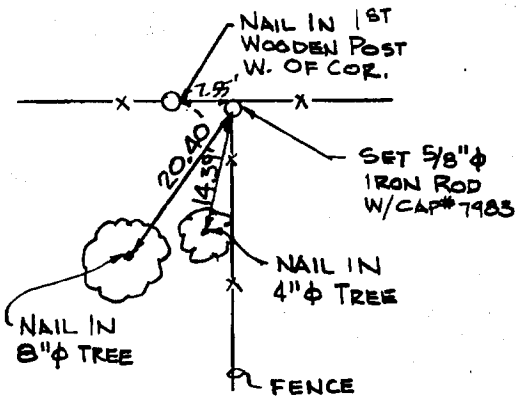
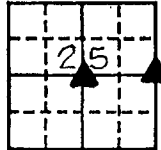

on cord

CENTER SECTION

E. 1/4 CORNER

I hereby certify that the survey work was completed and this certificate was prepared by me or under my direct personal supervision and that I am a duly registered land surveyor under the laws of the state of Iowa.

Signature: James L. Egger
Name typed or printed: JAMES L. EGGER

Date: JAN. 2, 1997 Reg. No. 7983

Corners	List Corners to be Indexed		
	Section	Twp	Range
E. 1/4	25	84N.	1W.
CENTER	25	84N.	1W.

SEAL

